

The Park Bench

AEPNA Newsletter

Visit us online at aepna.org

President's Letter Truth or Legend?

I heard that Saddle Creek got its name from one Mr. Poppleton, a Union Pacific Railroad surveyor and lawyer, who carried his saddle in the back of the wagon. When he wanted to survey hard-to-reach spots, he'd unhitch the horse from the wagon, saddle it up and ride. Once, the saddle fell off the wagon and he didn't discover it until he was ready to switch to the horse. He went looking for the saddle and found it in a creek.

Oral histories are valuable, but it takes a lot of work to find documentary evidence to support the stories. We've all played "Telephone" and seen how a story can change with repetition. But we've also seen how some unbelievable stories prove true. After the May meeting, neighbors came forward with stories of the neighborhood that we hope will spur you to do a little sleuthing on your own. (See story on pages 3.)

Friday, September 5 is the official ribbon cutting of the new playground at S/V Park. AEPNA is planning a celebration with help from the City of Omaha, the Parks Department and neighbors. Please put this on your calendars now. Invite friends, neighbors, local businesses and family to come out and make it a celebration worthy of the work that went into raising \$50,000 for our match! Do you want to help in making this a celebration for the history books? Contact Eileen Slane at 402-553-5988.

Lt. Jerry Siedlik from the Southwest Precinct will join us at the July meeting to discuss Neighborhood Watch and address the recent rash of break-ins. And word on the street is that there may be samples from thegourmetgranola.com at the meeting, too. You don't want to miss it. See you there!

Avery Schwer

Next Meeting
Thursday, July 17
6:30 – 8:30 PM
St. Matthew's

Speakers & Topics:
Sustainability in the City
Glenn & Nicole
Wigodsky - neighbors,
gardeners, and owners of
thegourmetgranola.com

Neighborhood Watch
Lt. Jerry Siedlik

Please join us!

Abstract Thinking

Richard and Constance Hollenbeck have the original abstract of their home which shows that it was granted to a soldier who got it for service in the War of 1812 by order of President Buchanan (a year before the actual Homestead Act passed). The abstract documents the claims, counter-claims, quitclaims, liens and lawsuits on the property (and even include Byron Reed's Last Will and Testament!). A longtime area resident told them the home was once a dairy. Research in The City Directory of Omaha (main library downtown) would verify that and give a view of prior owners. If you have your original abstract, dig it out and read it to see how many famous Omahans played a part in your home's history!



your neighborhood bank  more

You may know us as the friendly, neighborhood bank. But there's more to the story than that. Here, you'll find mortgage experts to help with all of your purchasing, refinancing, and home equity loan needs. You'll find experienced financial advisors who can provide you with the custom planning and consultation you need to meet any dream. Plus, you'll find insurance experts who know how to save you money on anything from home, auto, and life to business and health insurance. Best of all, you can find it right here. In your neighborhood. What more could you ask for?



A BRANCH OF SECURITY STATE BANK | MEMBER FDIC

50th and Underwood dundeebanking.com

EQUAL HOUSING LENDER.

Securities offered through Securities America Inc., Member FINRA/SIPC. Advisory services offered through Securities America Advisors, Inc. Dundee Bank dba Dundee Financial Services and the Securities America companies are unaffiliated.

NOT A DEPOSIT. NOT FDIC INSURED. NOT INSURED BY ANY GOVERNMENT AGENCY. NOT BANK GUARANTEED. MAY LOSE VALUE.

Aksarben-Elmwood Park Neighborhood Association

Executive Board

President – Avery Schwer
402-554-2777

V.P. – Angie Podoll
402-699-0300

Secretary – Tim Potter
402-830-5694

Treasurer – Eileen Slane
402-553-5988

Committees

Membership Director

Scott Swanson
402-553-1483

Community Service & Beautification

Open

Social Director

Lois Ourada

Media Director

Mike Kresnik

mikekresnik@gmail.com

Communications Director

Therese McGrath

tmcgra@creighton.edu

Newsletter

Editor – Colleen Ciciulla
402-556-3462

colleenciciulla@gmail.com

We welcome ideas and photos for the newsletter. Send articles,

information and photos to colleenciciulla@gmail.com.

Publisher – Ellen Shurson
402-714-1016

ellenshurson@gmail.com

The Aksarben Elmwood Park Neighborhood Association newsletter is published monthly by Shurson Publishing. Direct all advertising inquiries to 402-714-1016.

No warranties of the products or services printed herein are express or implied by either the Association or Shurson Publishing.

When Midtown was West Omaha

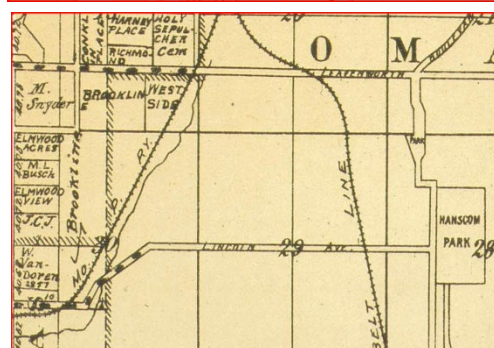

Old maps of the area show surprising changes in our city and landmarks that we take for granted. The maps below are roughly of the same area in 1899 and 1913.

Familiar landmarks are Holy Sepulchre Cemetery, County Hospital and Hanscom Park.

Lincoln Avenue (now Center Street) was once the city limit with odd jogs near 60th Street. Rogene Foy explained that was an accommodation for a prominent citizen who lived on the south side of the street, but wanted to be in the city limits so his child could take advantage of city services.

(Taken from Atlas & Plat Book of Douglas & Sarpy Counties, Nebraska, published by C.H. Scoville in 1899 & 1913)

These maps and many other rich historical artifacts are available at the Omaha Public Library (OPL) on the 3rd floor of the main library downtown along with old copies of the City Directory which is organized both alphabetically and by street, so you can find out who lived at your address or where someone you know used to live. Many of the resources are available online, and are helpful for doing genealogical research. Some of the digital archives require an OPL card, but others are available to the public in general. The Sanborn Fire Insurance maps are an amazing resource. Once you start browsing, you'll find it hard to stop!

Check out the resources available at:

<http://guides.omahalibrary.org/>

<http://digital.omahalibrary.org/earlynebraska/home.html>

AEPNA Membership Form

Name: _____

Address: _____

Phone: _____

Email Address: _____

Type: Household \$10.00 Business \$20.00
 New Renewal Gift

Please make check payable to Aksarben-Elmwood Park NA
Mail to: 1302 S. 56 St. Omaha, NE 68106

P.O. Box 6665
Omaha, NE 68106

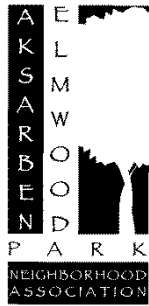

PRSR STD

US Postage

PAID

Omaha, NE

Permit 1638

“Hopefully, ghost stories and anecdotes get passed along to new owners by the neighbors. We have quite a few interesting anecdotes from our older neighbors. Our house certainly has character.

The two foot addition to our garage front? Built because Earl owned a series of Cadillacs and one just didn't quite fit.” Trina Westman

Remember the Airmail Landing Strip at Aksarben Field?

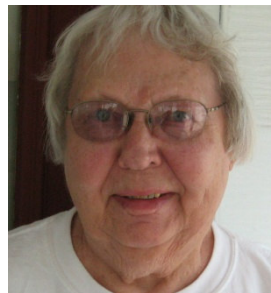

“My father worked for the postal service. When a night airmail flight was expected, he and other workers would line up their cars – facing each other on either side of the landing strip at Aksarben to illuminate the runway.”

Reminiscence of Rogene Foy

AEPNA member and longtime neighbor

AEPNA Business Members

- * Anderson Industrial Engines Co. * Bailey's Landscape & Design * Broadmoor *
- * Cars R'Us Auto Body * Circle Theatre * Clooty Tree Massage * Courtyard by Marriott *
- * Elmwood Tower * Godfather's Pizza/Aksarben Village * Hertz Equipment Rental * Hy-Vee *
- * JCoco * Learning Headquarters * LIV Lounge * Mt. Calvary Lutheran Church & School *
- * Noddle Companies * Olsson Associates * Pinhook Flats * Pruitt Outdoor Power *
- * Sandra Turner Real Estate * Security National Bank/Aksarben Village *
- * Shurson Publishing * St. Mathew Lutheran Church * Tasty Pastry * Tracks *
- * UNO College of Business * UNO Community Relations * Village Canvas and Cabernet *